

Proposed \$32,580,000 Capital Project  
No Tax Increase



# \$32M CAPITAL IMPROVEMENT PROJECT

Jordan-Elbridge Central School District



Public Vote

Tuesday, December 17th, 2024

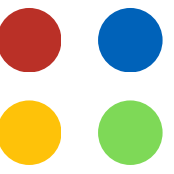

# Improvements Across the District

Proposed improvements across the district impact instructional, extracurricular, and athletic programs for all students.



# High School



## RENOVATION & IMPROVEMENTS



- 1967 Science Classrooms/Wing
- Music/Band Classrooms
- Gymnasium & Locker Rooms
- HVAC, Site, Elevator Renovations
- EVOLV Security Portal



# Science Classrooms

## RENOVATION OF ORIGINAL 1967 CLASSROOM SPACES

Science classrooms built in 1967 lack modern technology, flexible layouts, and safety features essential for current STEM instruction. Renovating these spaces supports hands-on learning, collaboration, and the use of advanced tools, aligning with contemporary educational standards and practices.

SEE MORE



# HS Gymnasium

## INSTALLATION OF NEW FLOOR REDESIGN FOR OPTIMAL VIEWING LOCKER ROOM & TRAINER RENOVATION

Flexible viewing in a high school gymnasium allows for adjustable seating arrangements, accommodating various events and maximizing space efficiency. It enhances spectator experience, supports diverse activities, and ensures safety, all while improving overall functionality for school events and competitions.

SEE MORE



# Locker Rooms

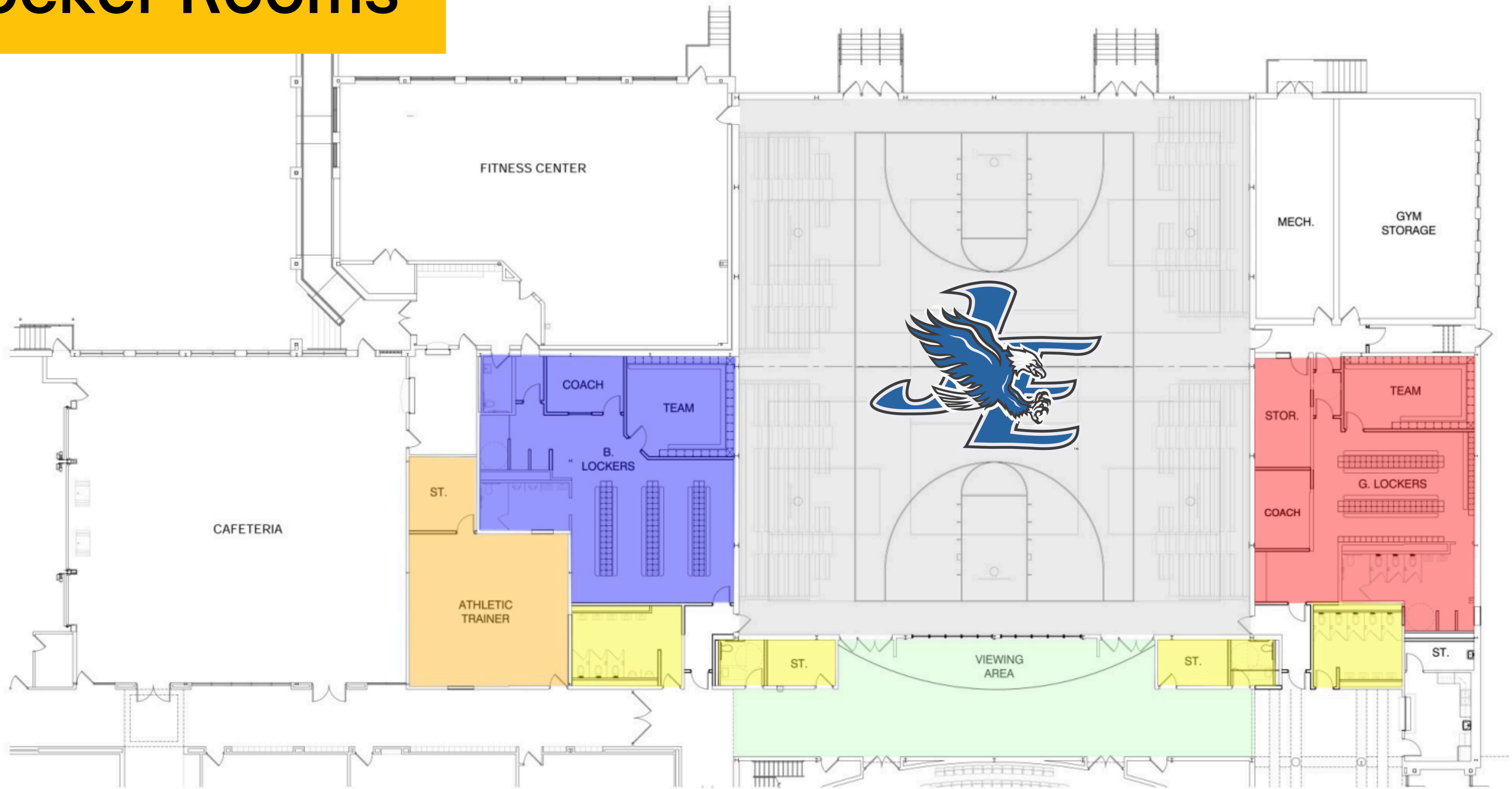

**Proposed Floor Plan**

# HS Band/Chorus

**Building Security Upgrades**  
**Elevator Modernization**  
**HVAC Equipment & Control Replacement**  
**Site Work Restoration & Improvements**  
**Classroom Ceiling & Flooring Replacements**  
**Priority Items from Building Condition Survey**

**Gymnasium & Support Area Renovations**

**Corridor Upgrades**

**Science Room Renovations**

**Band / Music Room Upgrades**

**Auditorium Theatrical Upgrades**

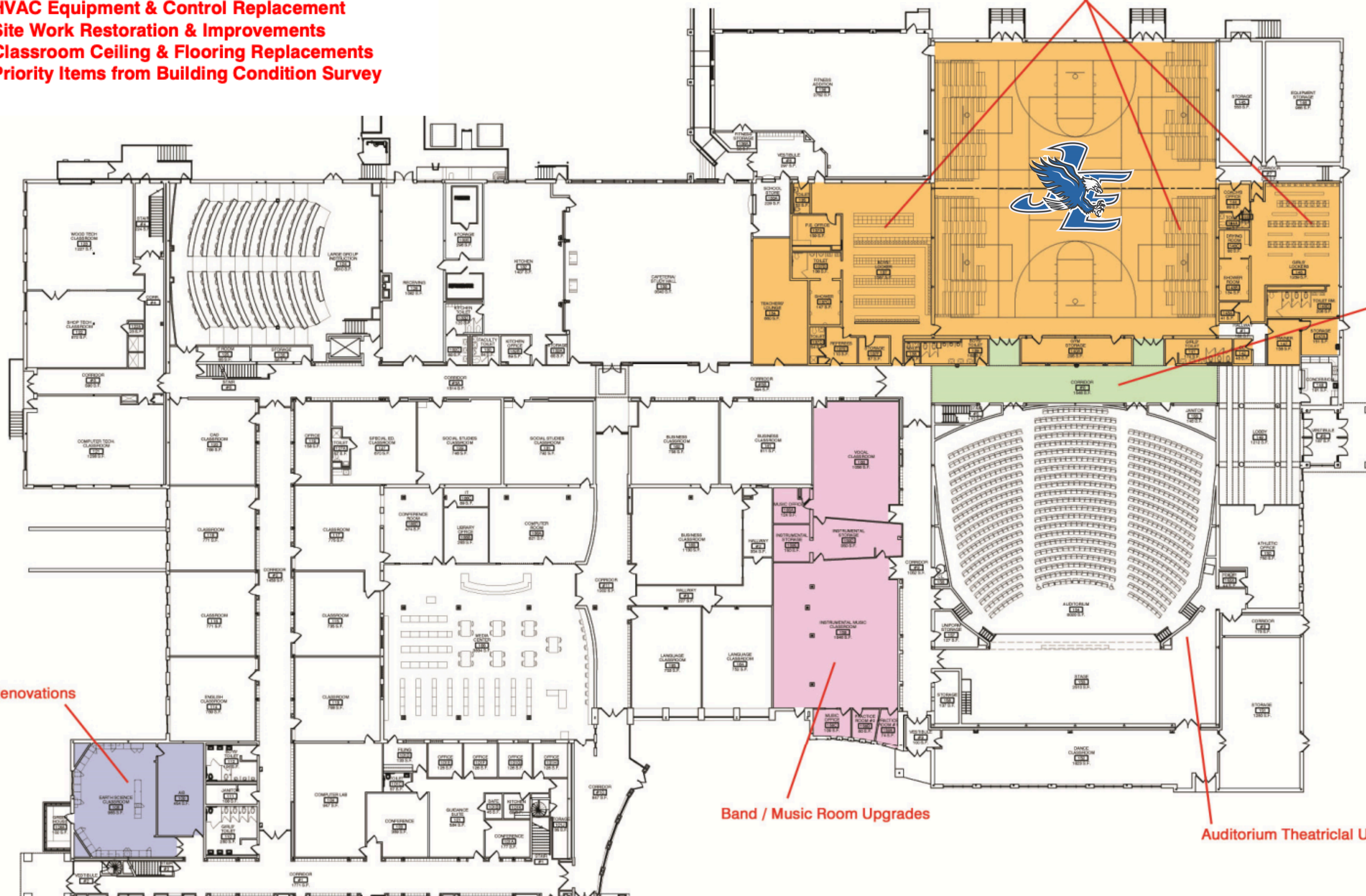

# HS Band/Chorus



# Security

## EVOLV SECURITY SYSTEM

The Evolv security system uses advanced sensor technology to screen individuals without the need for traditional metal detectors. It enhances safety by quickly detecting potential threats while allowing for a smooth, non-intrusive entry process, improving security efficiency in schools.



<https://evolv.showpad.com/share/z64q6CrbM2DZI1i5WYjrm>

# Middle School



## RENOVATION & IMPROVEMENTS



- Turf baseball & softball fields
- Theater upgrades in auditorium
- HVAC, Site, Elevator Renovations
- EVOLV Security Portal



# Turf Fields

## INSTALLATION OF TURF BASEBALL & SOFTBALL FIELDS

Turfed baseball and softball fields provide durability, reducing maintenance costs and ensuring year-round playability. They offer consistent playing conditions, minimize weather-related disruptions, and support increased use for practice, games, and community events, enhancing athletic opportunities for student athletes.

[SEE MORE](#) 







# Auditorium Upgrades

## AUDIO/VISUAL UPGRADES TO ENHANCE THEATRICAL EFFECT

Upgrading audio/visual systems in a middle school auditorium enriches sound clarity, visual impact, and lighting dynamics, immersing audiences while boosting student performers' confidence and ensuring professional-quality experiences for both actors and viewers.

SEE MORE



# MS - Locker Rooms

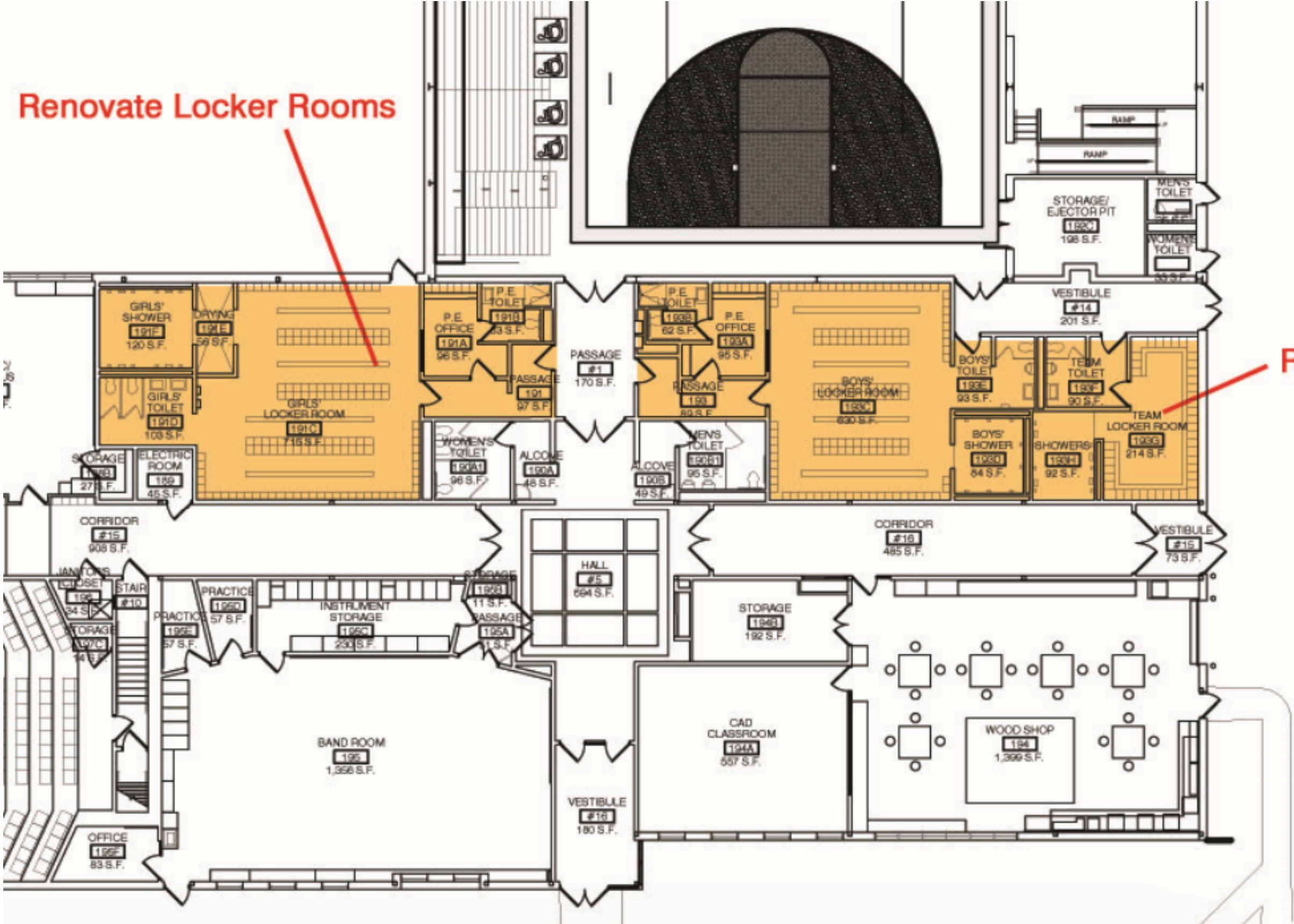

Renovate Locker Rooms

Renovate Locker Rooms

# Elementary School



## RENOVATION & IMPROVEMENTS



- Air conditioning throughout building
- Bus loop & Parking
- Music/Band Classrooms
- OT/PT Classrooms
- HVAC, Bathroom, Elevator Renovations
- EVOLV Security Portal

# Bus Loop / Parking

## IMPROVEMENTS TO PARKING DISCONTINUE NEED TO USE BROWN ST.

An improved bus loop enhances safety and efficiency during arrival and dismissal by reducing congestion, minimizing delays, and allowing smoother traffic flow. It ensures a safer environment for students and streamlines transportation, helping to keep schedules on track.

SEE MORE



# EE - Interior

Classroom Air Conditioning  
Building Security Upgrades  
Elevator Modernization  
HVAC Equipment Upgrades

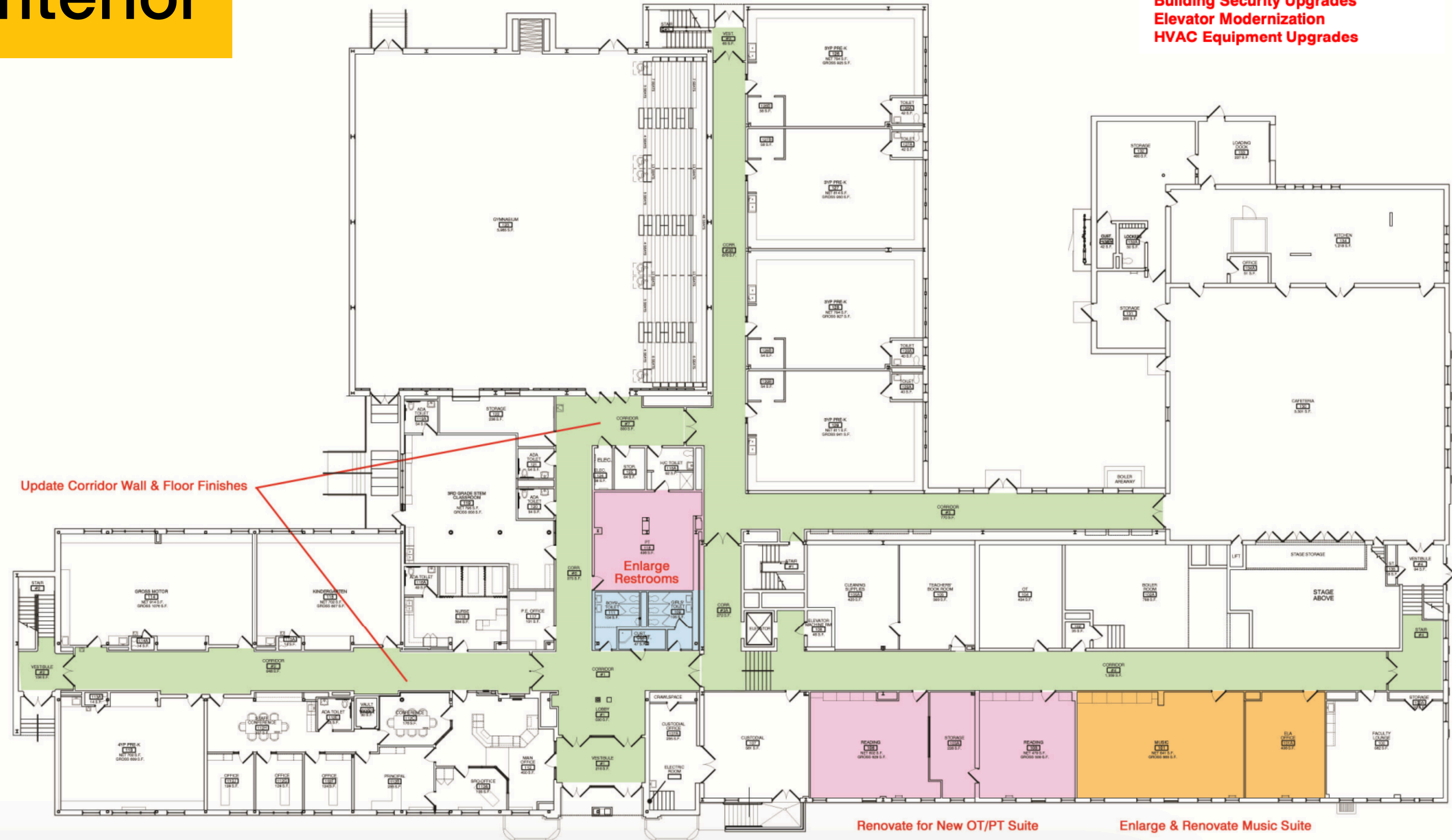

Update Corridor Wall & Floor Finishes

Enlarge Restrooms

Renovate for New OT/PT Suite

Enlarge & Renovate Music Suite

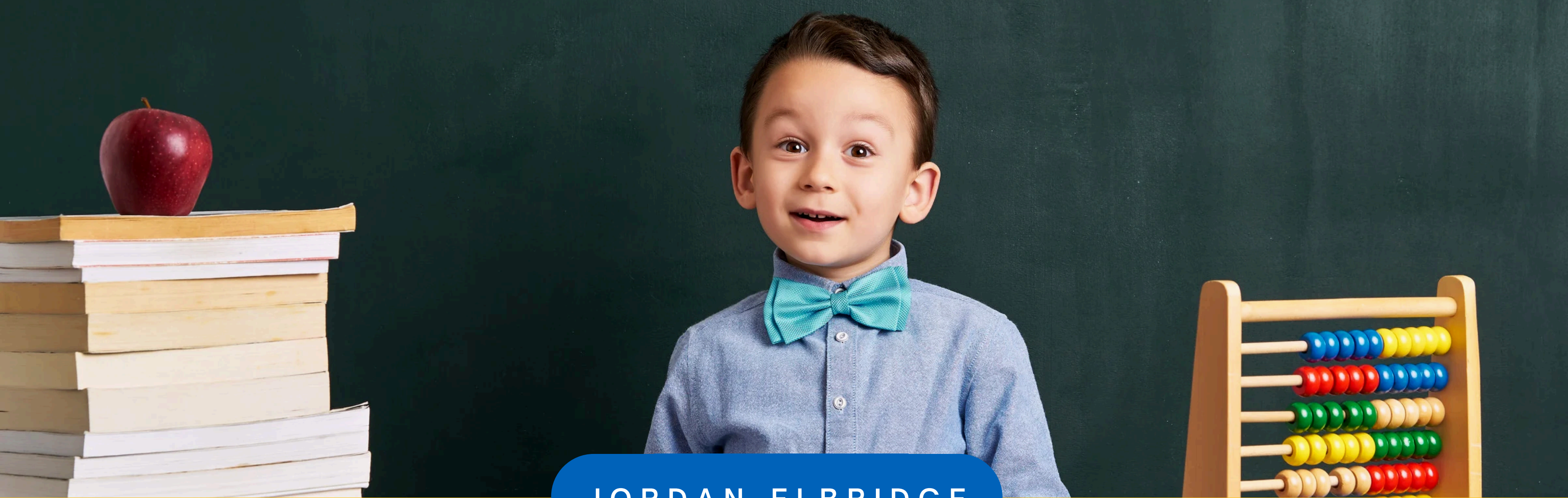

JORDAN-ELBRIDGE

## CULTIVATING THE BEST IN PERSONAL GROWTH AND ACHIEVEMENT

### CHILDREN FIRST.

A capital project can enhance student learning by providing modern, flexible spaces that support collaboration, technology integration, and specialized programs. Improved facilities promote engagement, create a conducive learning environment, and enable innovative teaching methods, all of which contribute to better academic outcomes and overall student success.

# THREE-SCHOOL BREAKDOWN

## HOW THIS FUNDING IS SPENT

**No Proposed Tax Increase**  
**Proposed Capital Project:**  
**\$32,580,000**

Jordan-Elbridge  
Middle School  
**\$9,275,470**



Elbridge  
Elementary  
**\$10,531,410**



Jordan-Elbridge  
High School  
**\$12,773,120**



Source: Project Costs  
provided by RSA,  
9/11/2024

**\$32,580,000**  
**Proposed Project**



**No proposed  
tax increase**



**\$4,000,000**  
**Reserve use**



**Old debt being  
paid off**



Jordan-Elbridge Central School District

SUMMARY OF EXISTING and FUTURE BUILDING DEBT SERVICE

	A	B	C (A+B)	D	E	F (C-D-E)	
<b>Building Debt Excluding Capital Outlay Projects and BOCES Projects</b>							
<u>Fiscal Year</u> <u>Ending June 30:</u>	<u>Total Principal</u>	<u>Total Interest</u>	<u>Total Debt</u> <u>Service</u>	<u>Estimated</u> <u>Building Aid</u>	<u>Debt Service</u> <u>Offsets</u>	<u>Estimated Net</u> <u>Local Share</u>	<u>\$ Change</u> <u>(F)</u>
2025	\$ 2,150,000	\$ 438,131	\$ 2,588,131	\$ 2,407,947	\$ -	\$ 180,184	
2026	2,225,000	336,813	2,561,813	2,377,789	-	184,023	\$ 3,839
2027	1,435,000	253,538	1,688,538	1,524,216	-	164,322	(19,702)
2028	780,000	205,338	985,338	1,150,072	-	(164,734)	(329,056)
2029	770,000	173,400	943,400	1,092,973	-	(149,573)	15,161
2030	720,000	141,200	861,200	1,021,579	-	(160,379)	(10,806)
2031	710,000	109,250	819,250	962,438	-	(143,188)	17,192
2032	745,000	76,450	821,450	921,803	-	(100,353)	42,834
2033	780,000	42,050	822,050	921,803	-	(99,753)	600
2034	95,000	5,900	100,900	249,157	-	(148,257)	(48,504)
2035	100,000	4,000	104,000	180,652	-	(76,652)	71,606
2036	100,000	2,000	102,000	180,652	-	(78,652)	(2,000)
<b>Totals</b>	<b>\$ 10,610,000</b>	<b>\$ 1,788,069</b>	<b>\$ 12,398,069</b>	<b>\$ 12,991,082</b>	<b>\$ -</b>	<b>\$ (593,013)</b>	



**Jordan-Elbridge Central School District**  
Estimated Net Local Share of Existing and Future Building Debt Service  
(Excludes Capital Outlay Projects and BOCES Projects)

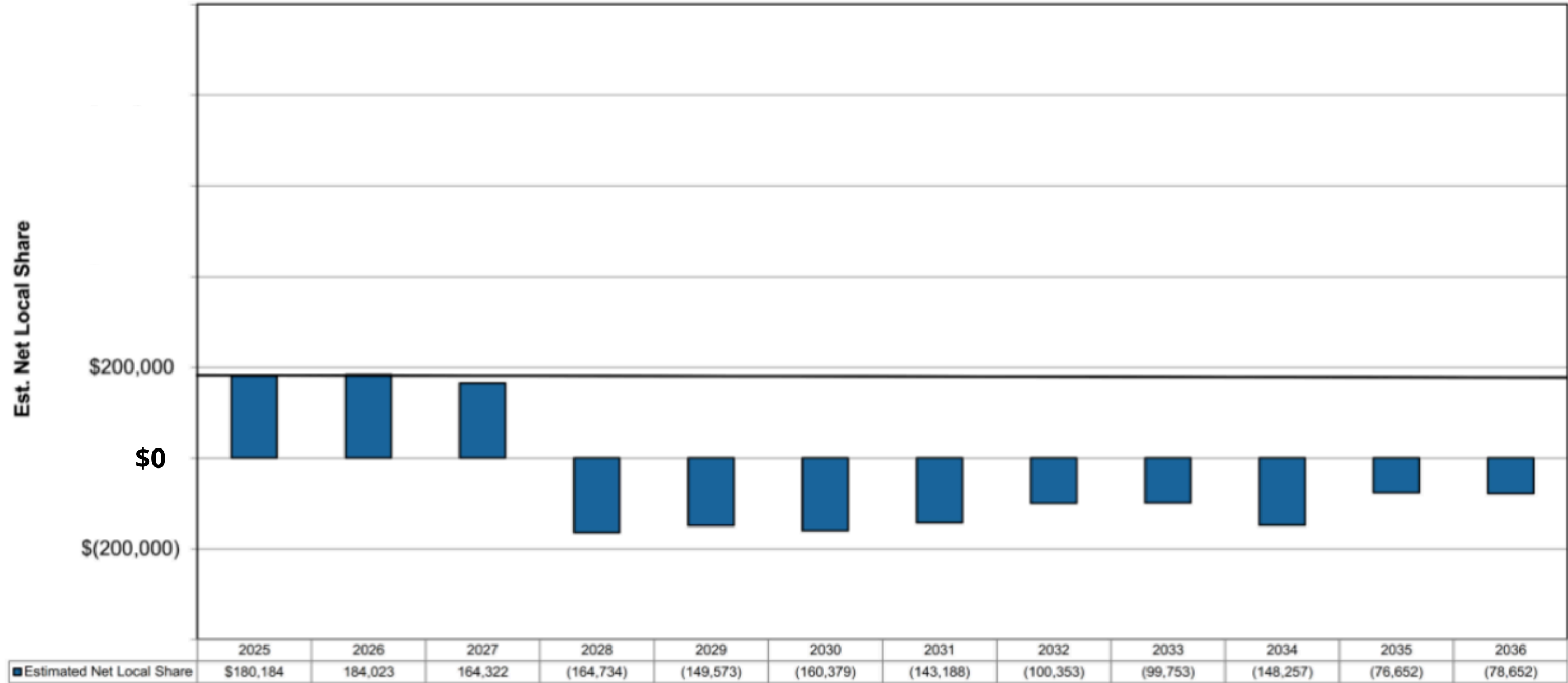

Fiscal Year Ending June 30



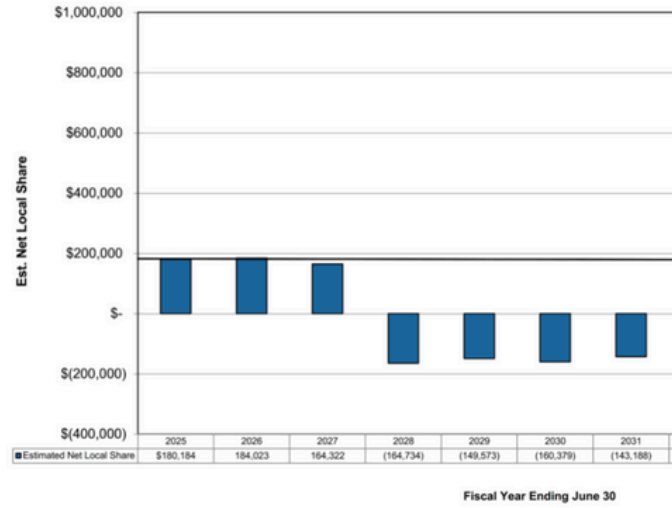

**Jordan-Elbridge Central School District**  
Estimated Net Local Share of Existing and Future Building Debt Service  
(Excludes Capital Outlay Projects and BOCES Projects)

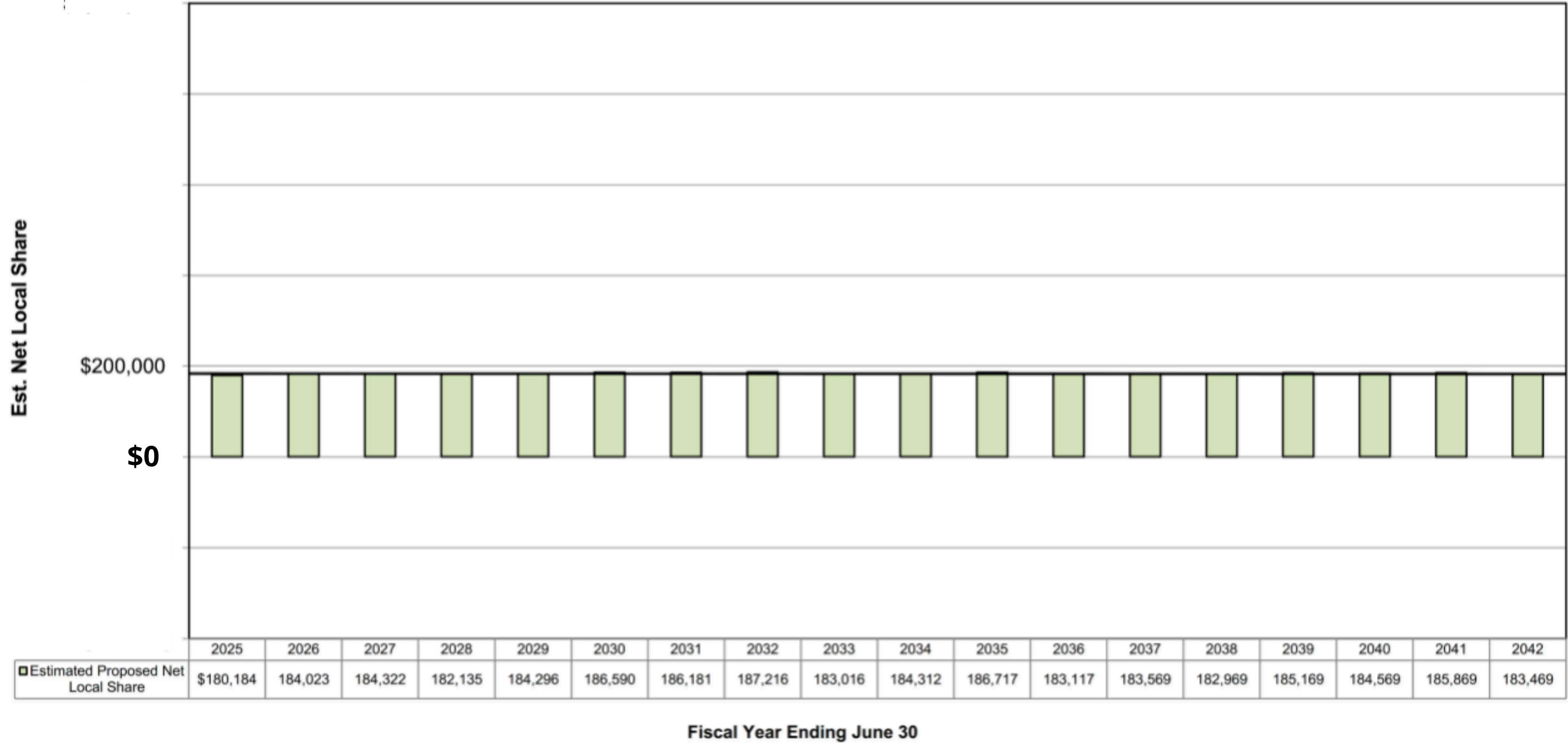

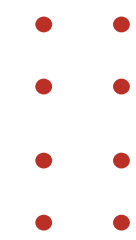

# Public Vote Tuesday, Dec. 17th

---

7 am - 9 pm

High School Events Entry



[www.jecsd.org](http://www.jecsd.org)

